

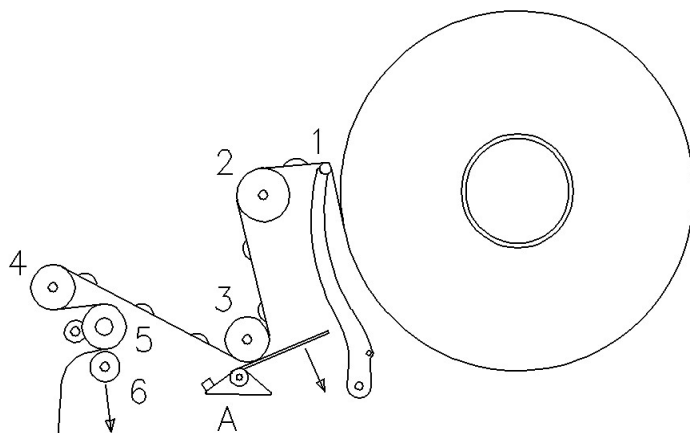

This card should be kept with the Auto-Dot-Dispenser at all times.

Chapter 1: Quick start menu for Auto-Dot-Dispenser

- Place dispenser on even surface.
- Connect dispenser to power adapter.
- Connect power adapter to power source.
- Make sure the machine is switched off (switch 0).
- Place the tape with dots on the machine, according to figure.
- Switch the machine on (switch 1).
- Press roller (4) and make sure the dispenser feeds a new dot.
- When the dot is not on the right position: Adjust roller (4) by moving it in the groove.
- Press roller (4) to check the new position of the dot.
- If necessary repeat above mentioned steps.
- The dispenser is ready for use.
- Switch the machine off when not in use.
- Also disconnect the power adapter when machine is not in use.



Chapter 2: Maintenance

General directions:

The dispenser must be free of left behind dots. Especially the places that come in contact with the carrier tape with dots. (pos. 1, pos. 2 and under roller 3)

Erase all contaminations. This can be done by rubbing with your fingers. When necessary, clean the parts only with wooden or plastic tools, soft tissues and cleaning agents. Never use sharp tools, this can damage the machine, especially the coated rollers (3) and (5).

Special attention is needed for:

1. The gap between coated roller (3) and switching lever. If the contaminations are hard to erase, the coated roller (3) can be removed. After the roller (3) is refitted it is sometimes necessary to re-adjust the switching lever. See Chapter 4
2. The T-shaped arm. When dots stick accidentally to the underside of the tape, they end up on top of the T-shaped arm. This can cause malfunctions.
3. Roller (5) with the red covered surface and 2 O-rings. Never use sharp tools as the surface and rings are easily damaged.

Chapter 3: Troubleshooting Auto-Dot-Dispenser

3.1 The dispenser does not react on pressing roller (4).

- Make sure the switch is **on**. (switch 1).
- Make sure the small power plug is connected to the dispenser.
- Make sure the power adapter is connected to the power source.

3.2 The dispenser does not stop feeding when turned on (switch 1).

- Make sure there are dots on the carrier tape.
- Make sure the gap under the coated roller (3) is not contaminated.
- The dots are too thin (less than 0,25 mm).
- The switching lever is not adjusted well. Adjust the switching lever. Chapter 4.

If none of these solutions seem to help, contact your supplier.

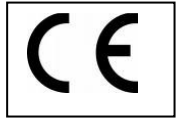

Chapter 4: Adjust switching lever

General directions:

For the best setup of the switching lever it is important to use the thinnest dots. These are usually found at the end of the carrier tape. Otherwise the dispenser will, when at the end of the tape, not recognise the dots anymore. The mentioned procedure guarantees the best setup of the switching lever.

If you encounter lots of problems with too thin dots, we advise you to reclame at your supplier. The dots must be at least 0,25 mm thick.

Adjusting procedure

1. Free the dispenser from carrier tape.
2. Make sure there are no dots left behind.
3. Take 30 cm of carrier tape without dots.
4. Place one end of this tape between coater roller (3) and the switching lever (Fig. 1).
5. Turn adjusting lever (A) **counter clockwise**. (Fig. 2 Fig. 6)
6. Switch the dispenser **on**.
7. Turn adjusting lever (A) **slowly** clockwise, until the motor starts running. (Fig. 3)
8. Check the switching moment, by pulling the carrier tape without dots. The coated roller will rotate with the tape. The motor must **not stop**. (Fig. 4)
9. If the motor does stop, leave it in **this position** and repeat from step 5.
10. Slowly pull a piece of carrier tape **with dots** under the coated roller (3). At every dot the motor must start and stop. (Fig. 5)
11. If not, repeat procedure.
12. It is ready for use, now set up the dispenser as in Chapter 1.



Fig. 1

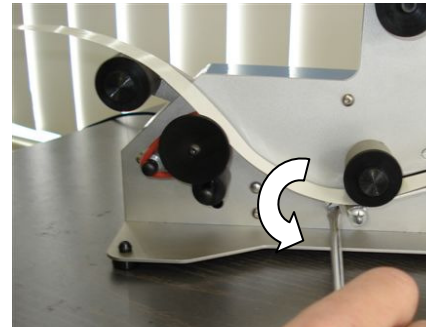

Fig. 2

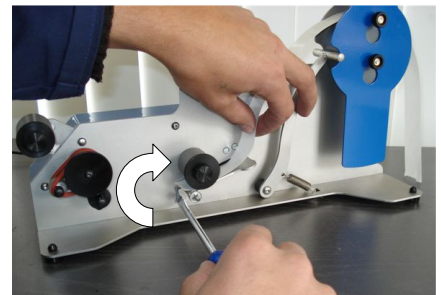

Fig. 3

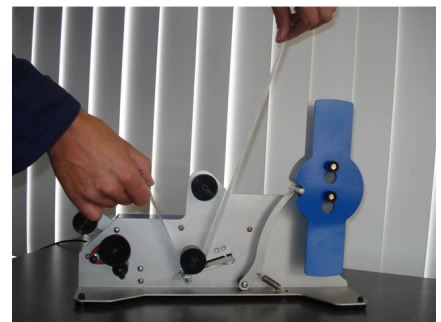

Fig. 4



Fig. 5

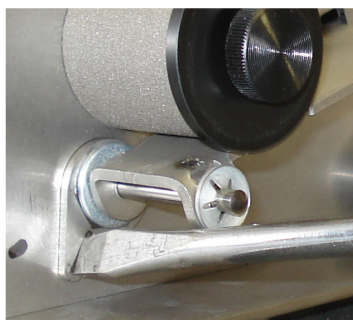

Fig 6 Screwdriver control